

**Mass properties PM10**

Density = 2700.0000 kg/m<sup>3</sup>

Mass = 0.5809 kg/m

Area = 215.160 mm<sup>2</sup>

Centroid relative to output coordinate system origin:

X = 0.00  
Y = -3.69  
Z = 0.00

I<sub>x</sub> = 17394.79 mm<sup>4</sup>

I<sub>y</sub> = 35905.97 mm<sup>4</sup>

J = 20793 mm<sup>4</sup>

R<sub>x</sub> = +8.99 mm

R<sub>y</sub> = +12.92 mm

Material: 6106-T6 Aluminium

Ultimate Tensile Strength (min.): 235 MPa  
Welded (min.): 148 MPa

Yield Tensile Strength (min.): 210 MPa  
Welded (min.): 120 MPa

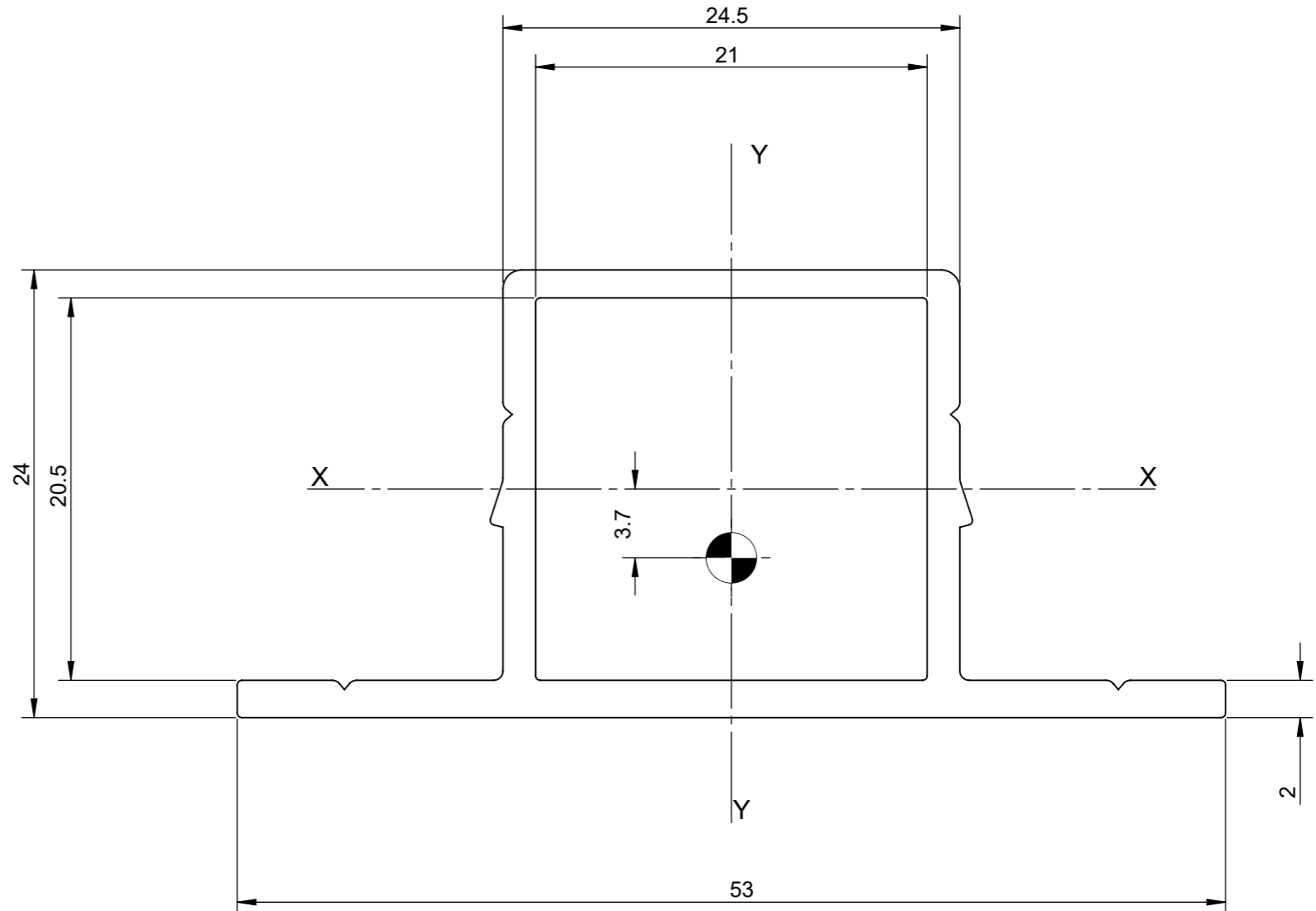

PM10 EXTRUSION PROFILE		
MONKEYTOE - AUSTRALIA		
DWG No: 2004-PM10	01/02/2019	
	SHEET 1 OF 1	A3
	SCALE 3:1	REV:02
DO NOT SCALE	DIMENSIONS IN MILLIMETERS	